



Licensing Sub-Committee Thursday, 7th January, 2016

You are invited to attend the next meeting of **Licensing Sub-Committee**, which will be held at:

**Council Chamber, Civic Offices, High Street, Epping
on Thursday, 7th January, 2016
at 10.00 am .**

**Glen Chipp
Chief Executive**

**Democratic Services
Officer**

A Hendry (Direct Line 01992 564246)
Email: democraticservices@eppingforestdc.gov.uk

Members:

Councillors A Boyce (Chairman), D Dorrell, P Keska and A Lion

PLEASE NOTE THE START TIME OF THE MEETING

- 1. APOLOGIES FOR ABSENCE**
- 2. DECLARATIONS OF INTEREST**

(Director of Governance) To declare interests in any item on this agenda.

- 3. PROCEDURE FOR THE CONDUCT OF BUSINESS (Pages 5 - 12)**
- 4. EXCLUSION OF PUBLIC AND PRESS**

Exclusion: To consider whether, under Section 100(A)(4) of the Local Government Act 1972, the public and press should be excluded from the meeting for the items of business set out below on grounds that they will involve the likely disclosure of exempt information as defined in the following paragraph(s) of Part 1 of Schedule 12A of the Act (as amended) or are confidential under Section 100(A)(2):

Agenda Item No	Subject	Exempt Information Paragraph Number
5	Local Government (Miscellaneous Provisions) Act 1976 – Mr Wilkinson	1

The Local Government (Access to Information) (Variation) Order 2006, which came into effect on 1 March 2006, requires the Council to consider whether maintaining the exemption listed above outweighs the potential public interest in disclosing the information. Any member who considers that this test should be applied to any currently exempted matter on this agenda should contact the proper officer at least 24 hours prior to the meeting.

Confidential Items Commencement: Paragraph 9 of the Council Procedure Rules contained in the Constitution require:

- (1) All business of the Council requiring to be transacted in the presence of the press and public to be completed by 10.00 p.m. at the latest.
- (2) At the time appointed under (1) above, the Chairman shall permit the completion of debate on any item still under consideration, and at his or her discretion, any other remaining business whereupon the Council shall proceed to exclude the public and press.
- (3) Any public business remaining to be dealt with shall be deferred until after the completion of the private part of the meeting, including items submitted for report rather than decision.

Background Papers: Paragraph 8 of the Access to Information Procedure Rules of the Constitution define background papers as being documents relating to the subject matter of the report which in the Proper Officer's opinion:

- (a) disclose any facts or matters on which the report or an important part of the report is based; and
- (b) have been relied on to a material extent in preparing the report and does not include published works or those which disclose exempt or confidential information (as defined in Rule 10) and in respect of executive reports, the advice of any political advisor.

Inspection of background papers may be arranged by contacting the officer responsible for the item.

5. LOCAL GOVERNMENT (MISCELLANEOUS PROVISIONS) ACT 1976 AS AMENDED & TOWN & POLICE CLAUSES ACT 1847 - DRIVER'S LICENCE MR WILKINSON (Pages 13 - 16)

(Director of Neighbourhoods) To consider the attached report.

6. INCLUSION OF PUBLIC AND PRESS

To invite the public and press back into the meeting for the remaining items of business.

7. NEW PREMISES LICENCE - JUST AT THE STATION, ROYDON STATION, 185 HIGH STREET, ROYDON CM19 5EA (Pages 17 - 62)

(Director of Neighbourhoods) To consider the attached report and documents.

This page is intentionally left blank

Agenda Item 3

PART 3(2) - RESPONSIBILITY FOR COUNCIL FUNCTIONS

APPENDIX 5

LICENSING COMMITTEE – TERMS OF REFERENCE

- (1) The full Committee shall comprise 15 Councillors appointed by the Council at its annual meeting, including a Chairman and Vice-Chairman.
- ... (2) For the functions set out in Annex 1, and the legislation listed in Annex 2, a Sub-Committee consisting of no more than any three Councillors drawn, in alphabetical order, from the members of the full Committee shall be formed. Any such Sub Committee shall include, by rota, one of the six Licensing Sub Committee Chairmen appointed at each Annual Council meeting.
- (3) For the transaction of business at full Committee meetings, the quorum shall be a minimum of five Committee members save that no business shall be transacted unless either the Chairman or Vice-Chairman of the Committee is present.
- (4) The Committee and Sub-Committees shall have full authority to hear and determine licensing applications.
- (5) The Committee and Sub-Committees shall be further empowered to determine appeals made against the decisions of the Head of Environmental Services taken under delegated authority on licensing applications.
- (6) The Committee shall at all times carry out its duties solely within the policy from time to time determined by the Council and shall conduct its proceedings in
... accordance with the requirements set out in Annex 3 (Conduct of Business by Licensing Committee and Sub-Committees).
- (7) The Licensing Committee shall take no part in the production or revision of the statement of licensing policy made under Section 5 of the Licensing Act 2003, however, they may determine policy under the legislation listed in Annex 3.
- (8) To be responsible for the consideration and approval of Designation Orders under Section 13 of the Criminal Justice and Police Act 2001 (Exercise of Controls over the consumption of alcohol in Public Places).

**PART 3(2) -
RESPONSIBILITY OF
FUNCTIONS (LICENSING
COMMITTEE)**

APPENDIX 5 (ANNEX 1)

LICENSING ACT 2003 – LIST OF FUNCTIONS AND DELEGATED AUTHORITY

Matter to be dealt with	Full Committee	Sub Committee	Officers
Application for personal licence		If a police objection	If no objection made
Application for personal licence with unspent convictions		All cases	
Application for premises licence/club premises certificate		If a relevant representation made	If no relevant representation made
Application for provisional statement		If a relevant representation made	If no relevant representation made
Application to vary premises licence/club premises certificate		If a relevant representation made	If no relevant representation made
Application to vary designated premises supervisor		If a police objection	All other cases
Request to be removed as designated premises supervisor			All cases
Application for transfer of premises licence		If a police objection	All other cases
Applications for interim Authorities		If a police objection	All other cases
Application to review premises licence/club premises certificate		All cases	
Decision on whether a complaint is irrelevant frivolous vexatious etc			All cases
Decision to object when local authority is a consultee and not the relevant authority considering the application		All cases	
Determination of a police objection to a temporary		All cases	

event notice			
All policy matters except the formulation of the statement of licensing policy	All cases		

RESPONSIBILITY

PART 3(2) –

**FOR FUNCTIONS
LICENSING COMMITTEE**

APPENDIX 5 (ANNEX 2)

LIST OF STATUTORY POWERS

Those functions pertaining to licensing and registration and permits and consents contained in the following legislation and any regulations, orders, byelaws or other subsidiary legislation made under the above Acts:

Animal Boarding Establishments Act 1963
Breeding & Sale of Dogs (Welfare) Act 1999
Breeding of Dogs Act 1973
Breeding of Dogs Act 1991
Caravan Sites & Control of Development Act 1960
Caravan Sites Act 1968
Dangerous Wild Animals Act 1976
Gambling Act 2005
Guard Dogs Act 1975
House to House Collections Act 1939
Licensing Act 2003
Local Government (Miscellaneous Provisions) Act 1976
Local Government (Miscellaneous Provisions) Act 1982
Pet Animals Act 1951
Pet Animals Act 1951 (Amendment) Act 1983
Riding Establishments Acts 1964 & 1970
Scrap Metal Dealers Act 1964
The Game Act 1831
Town Police Clauses Act 1847
Town Police Clauses Act 1889
Zoo Licensing Act 1981

**PART 3(2) – RESPONSIBILITY
FOR FUNCTIONS**

**APPENDIX 5
(ANNEX 3)**

**PART A – CONDUCT OF BUSINESS BY LICENSING COMMITTEE AND
SUB-COMMITTEES**

All references to committee in this annex shall be taken to infer a reference to the associated sub-committees.

1. General Conduct

- 1.1 All hearings of the Licensing Committee under the Licensing Act 2003, are to be held in accordance with the Personal Licences, Hearings, Premises Licences and Club Premises Certificates, and Licensing Register Regulations, made under the Licensing Act 2003.
- 1.2 The Council's Constitution shall regulate the conduct of and debate at meetings.
- 1.3 In the case of hearings under the Licensing Act 2003, the Committee shall only consider those matters relevant to the licensing objectives as set out in the Licensing Act 2003 and the statement of licensing policy adopted by the Council.

2. Declarations of Interest

- 2.1 Members of the Committee are subject to the Council's Code of Conduct and to advice from the Standard Board for England, details of which will be provided to those members.

3. Participation in the Hearing

- 3.1 Debate shall be restricted to members of the Licensing Committee. Where a local ward member, not being a member of the Committee, wishes to participate in the hearing, they may do so only with the permission of the Chairman and their participation shall be subject to the same rules as are applied to any other witnesses to the application.
- 3.2 In hearings other than those under the Licensing Act 2003, where a ward member is a member of the Committee, and wishes to object to the application, the member shall give 14 days' notice of their intention, and shall play no part in the decision-making process of the Committee. In hearings under the Licensing Act 2003, those named as responsible authorities and interested parties in the Act may only make representations within the time limits set out in the relevant statutory provisions.
- 3.3 All persons participating in the hearing shall be made aware of the limitations or scope of statements that will be acceptable and, in particular, that statements should be factual or a fair statement on a matter of public interest.

- 3.4 In the case of any hearing pursuant to the summary review procedure under the Violent Crime Reduction Act 2006, the membership of any Sub-Committee adjudicating on such a review shall comprise any three members drawn from the Licensing Committee subject to the proviso that no member should serve more than one hearing.

4. Attendance of the Public

- 4.1 The Council's Constitution and relevant statutory provisions relating to the admission or exclusion of the public shall apply to all meetings of the Licensing Committee.

5. Natural Justice

- 5.1 There are two elements to natural justice:

(a) Fairness

- (i) All persons affected by the decision or in the case of matters associated with the Licensing Act 2003, those named as responsible authorities and interested parties in the Act, will be allowed a hearing before a decision is made.
- (ii) Only objectors who can show clearly that they are affected by a decision shall be afforded the right to be heard or, in the case of hearings under the Licensing Act 2003, only those named in the Act as responsible authorities or interested parties.
- (iii) All information shall be made available, where possible in advance, to the applicant and the Committee.
- (iv) All members of the Committee shall be present throughout the hearing of a particular application. Where a member arrives late or leaves during a hearing of a particular application, that member shall play no part in the decision-making process. Where an application is adjourned it shall be continued by the same members only, and no others.
- (v) The Committee shall have discretion in respect of 'late' objections. Such objections shall be clearly marked on the agenda as such and the Committee shall decide on their acceptability. The applicant shall be advised of any late objections. In the case of representations made in relation to the Licensing Act 2003 applications, these shall only be accepted in accordance with the relevant statutory provisions.

(b) Prevention of Bias

- (i) The rules on the declarations of interest shall be firmly applied.
- (ii) If the Committee moves into private session to consider its decision, it shall be accompanied only by its advising officers, none of whom shall

have taken a substantive part in the hearing, and shall play no substantive part in the decision-making process.

6. General Procedures for Hearings

6.1 The following procedural requirements shall be followed at all times:

- (a) There shall be no recommendation from officers on the agenda;
- (b) The Committee shall be supplied with copies of all relevant documentation and the process and order of procedure shall be as follows:
 - (i) The Chairman will open the meeting and introduce persons as appropriate asking applicants and representatives to identify themselves.
 - (ii) The Chairman will outline the procedure to be followed.
 - (iii) The Lead Officer will outline the matter in hand.
 - (iv) The applicant or representative will present his/her case, with or without witnesses, and be questioned by members or any objectors/persons making representations present.
 - (v) Any objectors/persons making representations may then present their objections/representation, with or without witnesses, and be questioned by members or the applicant/s or their representative.
 - (vi) The objectors/persons making representations may make a final statement (without introducing new issues).
 - (vii) Finally, the applicant has the right to make a final statement (without introducing new issues).
 - (viii) All evidence/disclosures are to be made in the presence of all persons, unless someone voluntarily excuses themselves from the proceedings.
 - (ix) Committee members shall restrict themselves to questions and not discussion or comment.
 - (x) The applicant, objectors/persons making representations shall be allowed to ask officers questions of a technical/factual nature at any time during the proceedings.
 - (xi) An adjournment should be granted where to do otherwise would deny a fair hearing.
 - (xii) The Committee may resolve to decide upon the application in private session, however, if it becomes necessary to recall anyone

for additional information, everyone shall be invited to return to the Hearing.

- (xiii) The decision shall be given in the presence of all parties that wish to be present and confirmed in writing as soon as possible thereafter. If legal advice is given to members this advice will be repeated in summary form.

By virtue of paragraph(s) 1 of Part 1 of Schedule 12A
of the Local Government Act 1972.

Document is Restricted

This page is intentionally left blank

By virtue of paragraph(s) 1 of Part 1 of Schedule 12A
of the Local Government Act 1972.

Document is Restricted

This page is intentionally left blank

Report to the Licensing Sub-Committee

Date of meeting: Thursday 7th January 2016



**Epping Forest
District Council**

Subject:
Just at the Station,
Roydon Station,
185 High Street, Roydon, Essex CM19 5EA

Responsible Officer: Sarah Moran 01992 564270
Licensing Compliance Officer

Democratic Services: Adrian Hendry ext. 4246

Recommendations/Decisions Required:

To determine the application for a New Premises Licence under the Licensing Act 2003

Report:

Application

1. An application has been made by **Helen Kelly-Howe and Thomas Howe** trading as **Just at the Station Ltd**, for a New Premises licence for the above premises.

The authority received the application on **17th November 2015**. The application sets out the relevant licensing activities applied for and times requested: -

Proposed Operating Schedule.

- | | |
|--------------------------|---------------------------|
| • Live Music | Mon-Sun 12.00 – 01.00hrs |
| • Recorded music | Mon-Sun 11.00 – 01.30hrs |
| • Performance of dance | Mon-Sun 12.00 – 01.00hrs |
| • Dancing | Mon-Sun 12.00 – 01.00hrs |
| • Late night refreshment | Mon- Sun 23.00 – 01.30hrs |
| • Supply of alcohol | Mon- Sun 11.00 – 01.00hrs |

2. The Operating Schedule sets out conditions which will be attached to the licence if this application is granted.

Licensing Act 2003

3. When considering an application for a licence the licensing authority must have regard to the promotion of the licensing objectives.

These are—

- (a) **the prevention of crime and disorder;**
- (b) **public safety;**
- (c) **the prevention of public nuisance; and**
- (d) **the protection of children from harm.**

4. It must also have regard to its Statement of Licensing Policy and any guidance issued by the Secretary of State.

Consultation

5. The Responsible Authorities have received a copy of the application, it was properly advertised at the premises and in a local newspaper
6. The Licensing authority have received **one** representation from the responsible authority – ‘Essex Police’, with in the attached letter dated 10th December 2015 Peter Jones requested 4 conditions to be added to the Licence. Through the consultation Period the applicant and Peter Jones, have agreed to remove condition 2 and Amend condition 3. Condition 1 & 2 will remain and be added to the proposed Licence.
7. The Licensing Unit received an acknowledgement from Essex County Fire & Rescue Service, Environmental Health and no objections from Essex County Council Child protection.
8. The Licensing unit have received **11** representations from interested parties.
9. The representations relate to. The Prevention of Crime and Disorder, Public Safety & Public Nuisance

Guidance Issued by the Secretary of State

10. The Licensing Act 2003 provides that the licensing authority must ‘have regard to’ guidance issued by the Secretary of State under section 182.
11. Crime and Disorder 2.1 – 2.5, Public Safety 2.6 – 2.13 and Public Nuisance 2.14 – 2.30 of the Guidance are relevant to this application

Options

12. In determining this application the Sub-Committee may take any of the following steps as it considers necessary for the promotion of the licensing objectives, namely:
 - to modify the conditions of the Licence; or
 - to reject the whole or part of the application.

For the purposes of the Licensing Act 2003 the conditions of the licence are modified if any of them are altered or omitted or a new condition added.

Determination

The Sub-committee is asked to determine the application having regard to

- (a) the content of this report and representations
- (b) any additional information obtained from the hearing
- (c) the Council’s statement of licensing policy
- (d) Guidance issued by the Secretary of State, and
- (e) the steps appropriate to promote the licensing objectives.

Appeal

If any party is aggrieved with the decision they can appeal to Magistrates court. The appeal period is 21 days from notification of the decision.

Background Papers Used In Preparing This Report:

- The Licensing Act 2003
<http://www.legislation.gov.uk/ukpga/2003/17/contents?view=plain>

- The Secretary of State's Guidance issued under Section 182 Licensing Act 2003
<http://www.homeoffice.gov.uk/publications/alcohol-drugs/alcohol/guidance-section-182-licensing?view=Binary>
- Epping Forest District Council's statement of licensing policy.
<http://www.eppingforestdc.gov.uk>

Attached documents

- Application for a New Premises licence.
- Plan and Pictures of the Premises.
- Newspaper notice.
- Email from Peter Jones Essex Police and Applicant – Helen Kelly-Howe
- Acknowledgment letter from Essex County Fire & Rescue Service.
- Acknowledgment letter from Environmental Health Officer – Hasan Erdogan.
- Acknowledgment letter from Essex County Council Child Protection.
- 11 Representations from Interested Parties.
- Map showing the area.

This page is intentionally left blank

Rec: 17th Nov 2015
Consultation start 18th Nov 2015
End 15th Dec 2015

WK/201548144

Epping Forest District Council

Application for a premises licence to be granted under the Licensing Act 2003

PLEASE READ THE FOLLOWING INSTRUCTIONS FIRST

Before completing this form please read the guidance notes at the end of the form
If you are completing this form by hand please write legibly in block capitals. In all cases ensure that your answers are inside the boxes and written in black ink. Use additional sheets if necessary.
You may wish to keep a copy of the completed form for your records.

I/We JUST... AT THE STATION LTD apply for a premises licence under section 17 of
(Insert name(s) of applicant)
the Licensing Act 2003 for the premises described in Part 1 below (the premises)
and I/we are making this application to you as the relevant licensing authority in
accordance with section 12 of the Licensing Act 2003

Part 1 – Premises details

Postal address of premises or, if none, ordnance survey map reference or description <u>ROYDON STATION</u> <u>185 HIGH STREET</u> <u>ROYDON</u>	
Post town <u>ESSEX</u>	Post code <u>CM19 5EA 5EH</u>

Telephone number at premises (if any)

Non-domestic rateable value of premises

Part 2 - Applicant details

Please state whether you are applying for a premises licence as

Please tick yes

a) an individual or individuals*	<input type="checkbox"/>	please complete section (A)
b) a person other than an individual*		
i. as a limited company	<input checked="" type="checkbox"/>	please complete section (B)
ii. as a partnership	<input type="checkbox"/>	please complete section (B)
iii. as an unincorporated association or	<input type="checkbox"/>	please complete section (B)
iv. other (for example a statutory corporation)	<input type="checkbox"/>	please complete section (B)
c) a recognised club	<input type="checkbox"/>	please complete section (B)
d) a charity	<input type="checkbox"/>	please complete section (B)

- e) the proprietor of an educational establishment please complete section (B)
- f) a health service body please complete section (B)
- g) a person who is registered under Part 2 of the Care Standards Act 2000 (c14) in respect of an independent hospital please complete section (B)
- h) the chief officer of police of a police force in England and Wales please complete section (B)

*If you are applying as a person described in (a) or (b) please confirm:

Please tick yes

- I am carrying on or proposing to carry on a business which involves the use of the premises for licensable activities; or
- I am making the application pursuant to a
 - statutory function or
 - a function discharged by virtue of Her Majesty's prerogative

(A) INDIVIDUAL APPLICANTS (fill in as applicable)

Mr Mrs Miss Ms Other title (for example, Rev)

Surname **First names**

Please tick yes

I am 18 years old or over

Current postal address if different from premises address

Post Town **Postcode**

Daytime contact telephone number

E-mail address (optional)

SECOND INDIVIDUAL APPLICANT (if applicable)

Mr Mrs Miss Ms Other title (for example, Rev)

Surname

First names

Please tick
✓ yes

I am 18 years old or over

Current postal address if different from premises address

Post Town



Postcode

Daytime contact telephone number

E-mail address (optional)

(B) OTHER APPLICANTS.

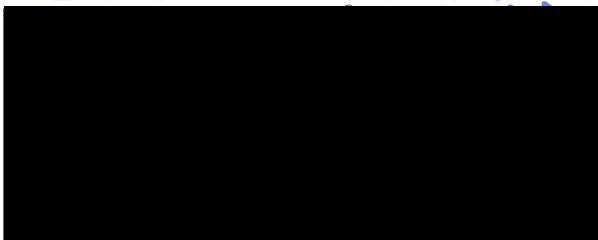
Please provide name and registered address of applicant in full. Where appropriate please give any registered number. In the case of a partnership or other joint venture (other than a body corporate), please give the name and address of each party concerned

Name	JUST... AT THE STATION LTD REG CO. NO. 9217614
Address	
Registered number (where applicable)	9217614
Description of applicant (for example partnership, company, unincorporated association etc)	LIMITED COMPANY
Telephone number (if any)	
E-mail address (optional)	

Part 3 Operating Schedule

When do you want the premises licence to start?

Day	Month	Year
17	11	2015

If you wish the licence to be valid only for a limited period, when do you want it to end?

Day	Month	Year

If 5,000 or more people are expected to attend the premises at any one time, please state the number expected to attend.

Please give a general description of the premises (please read guidance note 1)

Mediterranean Restaurant

What licensable activities do you intend to carry on from the premises?
(Please see sections 1 and 14 of the Licensing Act 2003 and Schedule 1 and 2 to the Licensing Act 2003)

Please tick ✓ yes

Provision of regulated entertainment

- a) plays (if ticking yes, fill in box A)
- b) films (if ticking yes, fill in box B)
- c) indoor sporting events (if ticking yes, fill in box C)
- d) boxing or wrestling entertainment (if ticking yes, fill in box D)
- e) live music (if ticking yes, fill in box E)
- f) recorded music (if ticking yes, fill in box F)
- g) performances of dance (if ticking yes, fill in box G)
- h) anything of a similar description to that falling within (e), (f) or (g)
(if ticking yes, fill in box H)

Provision of entertainment facilities for:

- i) making music (if ticking yes, fill in box I)
- j) dancing (if ticking yes, fill in box J)
- k) entertainment of a similar description to that falling within (i) or (j)
(if ticking yes, fill in box K)

Provision of late night refreshment (if ticking yes, fill in box L)

Supply of alcohol (if ticking yes, fill in box M)

In all cases complete boxes N, O and P

A

Plays Standard days and timings (please read guidance note 6)			Will the performance of a play take place indoors or outdoors or both – please tick [Y] (please read guidance note 2)	Indoors		
Day	Start	Finish		Outdoors		
Mon			Please give further details here (please read guidance note 3)	Both		
Tue						
Wed				State any seasonal variations for performing plays (please read guidance note 4)		
Thur						
Fri				Non standard timings. Where you intend to use the premises for the performance of plays at different times to those listed in the column on the left, please list (please read guidance note 5)		
Sat						
Sun						

B

Films Standard days and timings (please read guidance note 6)			Will the exhibition of films take place indoors or outdoors or both – please tick [Y] (please read guidance note 2)	Indoors		
Day	Start	Finish		Outdoors		
Mon			Please give further details here (please read guidance note 3)	Both		
Tue						
Wed				State any seasonal variations for the exhibition of films (please read guidance note 4)		
Thur						
Fri				Non standard timings. Where you intend to use the premises for the exhibition of films at different times to those listed in the column on the left, please list (please read guidance note 5)		
Sat						
Sun						

C

Indoor sporting events Standard days and timings (please read guidance note 6)			Please give further details (please read guidance note 3)
Day	Start	Finish	
Mon			State any seasonal variations for indoor sporting events (please read guidance note 4)
Tue			
Wed			Non standard timings. Where you intend to use the premises for indoor sporting events at different times to those listed in the column on the left, please list (please read guidance note 5)
Thur			
Fri			
Sat			
Sun			

D

Boxing or wrestling entertainments Standard days and timings (please read guidance note 6)			Will the boxing or wrestling entertainment take place indoors or outdoors or both – please tick [Y](please read guidance note 2)	Indoors	
Day	Start	Finish		Outdoors	
Mon			Both		Please give further details here (please read guidance note 3)
Tue					
Wed					State any seasonal variations for boxing or wrestling entertainment (please read guidance note 4)
Thur					
Fri					Non standard timings. Where you intend to use the premises for boxing or wrestling entertainment at different times to those listed in the column on the left, please list (please read guidance note 5)
Sat					
Sun					

E

Live music Standard days and timings (please read guidance note 6)			Will the performance of live music take place indoors or outdoors or both – please tick [Y] (please read guidance note 2)	Indoors	<input checked="" type="checkbox"/>
Day	Start	Finish		Outdoors	
Mon	12.00	01.00	<p>Please give further details here (please read guidance note 3) If we are hiring premises for a wedding/party we may like the possibility of live music</p> <p>State any seasonal variations for the performance of live music (please read guidance note 4)</p> <p>Non standard timings. Where you intend to use the premises for the performance of live music at different times to those listed in the column on the left, please list (please read guidance note 5)</p>	Both	
Tue	12.00	01.00			
Wed	12.00	01.00			
Thur	12.00	01.00			
Fri	12.00	01.00			
Sat	12.00	01.00			
Sun	12.00	01.00			

F

Recorded music Standard days and timings (please read guidance note 6)			Will the playing of recorded music take place indoors or outdoors or both – please tick [Y] (please read guidance note 2)	Indoors	<input checked="" type="checkbox"/>
Day	Start	Finish		Outdoors	
Mon	11.00	01.30	<p>Please give further details here (please read guidance note 3) If we are hiring premises or for background we will use recorded music.</p> <p>State any seasonal variations for playing recorded music (please read guidance note 4)</p> <p>Non standard timings. Where you intend to use the premises for the playing of recorded music entertainment at different times to those listed in the column on the left, please list (please read guidance note 5)</p>	Both	
Tue	11.00	01.30			
Wed	11.00	01.30			
Thur	11.00	01.30			
Fri	11.00	01.30			
Sat	11.00	01.30			
Sun	11.00	01.30			

G

Performances of dance Standard days and timings (please read guidance note 6)			Will the performance of dance take place indoors or outdoors or both – please tick [Y] (please read guidance note 2)	Indoors	<input checked="" type="checkbox"/>
				Outdoors	<input type="checkbox"/>
				Both	<input type="checkbox"/>
Day	Start	Finish	Please give further details here (please read guidance note 3) If we are using premises for a wedding / party they would like the possibility of dancing. State any seasonal variations for the performance of dance (please read guidance note 4) Non standard timings. Where you intend to use the premises for the performance of dance entertainment at different times to those listed in the column on the left, please list (please read guidance note 5)		
Mon	12.00	01.00			
Tue	12.00	01.00			
Wed	12.00	01.00			
Thur	12.00	01.00			
Fri	12.00	01.00			
Sat	12.00	01.00			
Sun	12.00	01.00			

H

Anything of a similar description to that falling within (e), (f) or (g) Standard days and timings (please read guidance note 6)			Please give a description of the type of entertainment you will be providing		
Day	Start	Finish	Will this entertainment take place indoors or outdoors or both – please tick [Y] (please read guidance note 2)	Indoor	<input type="checkbox"/>
				Outdoor	<input type="checkbox"/>
				Both	<input type="checkbox"/>
Mon			Please give further details here (please read guidance note 3) State any seasonal variations for entertainment of a similar description to that falling within (e), (f) or (g) (please read guidance note 4)		
Tue					
Wed					
Thur					
Fri					

Sat			<p>Non standard timings. Where you intend to use the premises for the entertainment of similar description to that falling within (e), (f) or (g) at different times to those listed in the column on the left, please list (please read guidance note 5)</p>
Sun			

Provision of facilities for making music Standard days and timings (please read guidance note 6)			Please give a description of the facilities for making music you will be providing							
			Will the facilities for making music be indoors or outdoors or both – please tick [Y] (please read guidance note 2)	<table border="1"> <tr> <td>Indoors</td> <td></td> </tr> <tr> <td>Outdoors</td> <td></td> </tr> <tr> <td>Both</td> <td></td> </tr> </table>	Indoors		Outdoors		Both	
Indoors										
Outdoors										
Both										
Day	Start	Finish								
Mon			Please give further details here (please read guidance note 3)							
Tue										
Wed										
Thur			State any seasonal variations for the provision of facilities for making music (please read guidance note 4)							
Fri										
Sat										
Sun			Non standard timings. Where you intend to use the premises for provision of facilities for making music entertainment at different times to those listed in the column on the left, please list (please read guidance note 5)							

Provision of facilities for dancing Standard days and timings (please read guidance note 6)			Will the facilities for dancing be indoors or outdoors or both – please tick [Y] (see guidance note 2)						
			<table border="1"> <tr> <td>Indoors</td> <td><input checked="" type="checkbox"/></td> </tr> <tr> <td>Outdoors</td> <td></td> </tr> <tr> <td>Both</td> <td></td> </tr> </table>	Indoors	<input checked="" type="checkbox"/>	Outdoors		Both	
Indoors	<input checked="" type="checkbox"/>								
Outdoors									
Both									
Day	Start	Finish							
			Please give a description of the facilities for dancing you will be providing						

Mon	12.00	01.00	Please give further details here (please read guidance note 3) If we are hiring premises for a wedding/party they may want to dance.
Tue	12.00	01.00	
Wed	12.00	01.00	State any seasonal variations for providing dancing facilities (please read guidance note 4)
Thur	12.00	01.00	
Fri	12.00	01.00	Non standard timings. Where you intend to use the premises for the provision of facilities for dancing entertainment at different times to those listed in the column on the left, please list (please read guidance note 5)
Sat	2.00	01.00	
Sun	2.00	01.00	

K

Provision of facilities for entertainment of a similar description to that falling within I or J Standard days and timings (please read guidance note 6)			Please give a description of the type of entertainment facility you will be providing	
Day	Start	Finish	Will the entertainment facility be indoors or outdoors or both – please tick [Y] (please read guidance note 2)	Indoor
Mon				Outdoor
				Both
Tue			Please give further details here (please read guidance note 3)	
Wed				
Thur			State any seasonal variations for the provision of facilities for entertainment of a similar description to that falling within j or k (please read guidance note 4)	
Fri				
Sat			Non standard timings. Where you intend to use the premises for the provision of facilities for entertainment of a similar description to that falling within I or J at different times to those listed in the column on the left, please list (please read guidance note 5)	
Sun				

L

Late night refreshment Standard days and timings (please read guidance note 6)			Will the provision of late night refreshment take place indoors or outdoors or both – please tick [Y] (please read guidance note 2)	Indoors	<input checked="" type="checkbox"/>
Day	Start	Finish		Outdoors	<input checked="" type="checkbox"/>
Mon	11pm	01.30am	Please give further details here (please read guidance note 3) late night refreshments/tea + coffee to be used as a wind down.	Both	<input type="checkbox"/>
Tue	23.00	01.30			
Wed	23.00	01.30		State any seasonal variations for the provision of late night refreshment (please read guidance note 4)	
Thur	23.00	01.30			
Fri	23.00	01.30		Non standard timings. Where you intend to use the premises for the provision of late night refreshment at different times, to those listed in the column on the left, please list (please read guidance note 5)	
Sat	23.00	01.30			
Sun	23.00	01.30			

M

Supply of alcohol Standard days and timings (please read guidance note 6)			Will the sale of alcohol be for consumption (Please tick box Y) (please read guidance note 7)	On the premises	<input checked="" type="checkbox"/>
Day	Start	Finish		Off the premises	<input checked="" type="checkbox"/>
Mon	11pm	01.00am	State any seasonal variations for the supply of alcohol (please read guidance note 4)	Both	<input type="checkbox"/>
Tue	11.00	01.00			
Wed	11.00	01.00			
Thur	11.00	01.00		Non-standard timings. Where you intend to use the premises for the supply of alcohol at different times to those listed in the column on the left, please list (please read guidance note 5)	
Fri	11.00	01.00			
Sat	11.00	01.00			

Sun	11.00	08.00	
-----	-------	-------	--

State the name and details of the individual whom you wish to specify on the licence as premises supervisor

Name: THOMAS ANDREW HOWE

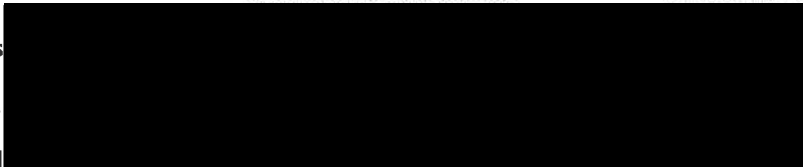
Address: 

Postcode: 

Personal Licence number(if known): Awaiting LBWF

Issuing licensing authority (if known): Awaiting LBWF

N

Please highlight any adult entertainment or services, activities, other entertainment or matters ancillary to the use of the premises that may give rise to concern in respect of children (please read guidance note 8)

O

Hours premises are open to the public Standard timings (please read guidance note 6)			State any seasonal variation (please read guidance note 4)
Day	Start	Finish	
Mon			Non standard timings. Where you intend to use the premises to be open to the public at different times from those listed in the column on the left, please list (please read guidance note 5)
Tue			
Wed			
Thur			
Fri			
Sat			
Sun			

P

Describe the steps you intend to take to promote the four licensing objectives:

a) General – all four licensing objectives (b,c,d,e) (please read guidance note 9)

~~THE PREMISES WILL INS~~

b) The prevention of crime and disorder

THE PREMISES WILL INSTALL AND MAINTAIN CCTV SYSTEM WHICH WILL RECORD FOR 28 DAYS. THIS WILL BE AVAILABLE IMMEDIATELY UPON ^{LAWFUL} REQUEST OF ESSEX POLICE OR RESPONSIBLE AUTHORITY. A STAFF MEMBER WILL BE CONVERSANT WITH CCTV SYSTEM AND AVAILABLE WHEN PREMISES ARE OPEN TO THE PUBLIC.

c) Public safety

Reasonable and adequate staff training will be carried out in relation to
a) dealing with incidents and crime/disorder prevention.
b) sale of alcohol to underage, persons over 18 purchasing for underage, drunk etc) prior to being allowed to sell alcohol.

d) The prevention of public nuisance

Notices shall be prominently displayed at all exits requesting patrons to leave quietly.

e) The protection of children from harm

The premises shall operate a challenge 25 age verification policy. Any person who appears to be under 25 shall be asked to produce photo I.D. to prove they are over 18. Failure to produce will result in service being refused. Acceptable forms of ID include:
a) Passport b) Photocard driving licence.
c) Photographic ID bearing 'PASS' hologram.

Please tick ✓ yes

- I have made or enclosed payment of the fee
- I have enclosed the plan of the premises
- I have sent copies of this application and the plan to responsible authorities and others where applicable
- I have enclosed the consent form completed by the individual I wish to be premises supervisor, if applicable
- I understand that I must now advertise my application
- I understand that if I do not comply with the above requirements my application will be rejected

IT IS AN OFFENCE, LIABLE ON CONVICTION TO A FINE UP TO LEVEL 5 ON THE STANDARD SCALE, UNDER SECTION 158 OF THE LICENSING ACT 2003, TO MAKE A FALSE STATEMENT IN OR IN CONNECTION WITH THIS APPLICATION

Part 4 – Signatures (please read guidance note 10)

Signature of applicant or applicant's solicitor or other duly authorised agent. (See guidance note 11) If signing on behalf of the applicant please state in what capacity.

Signature 

Date: 17/11/15

Capacity COMPANY SECRETARY

For joint applications signature of 2nd applicant or 2nd applicant's solicitor or other authorised agent. (please read guidance note 12) If signing on behalf of the applicant please state in what capacity.

Signature

Date

Capacity

Contact name (where not previously given) and postal address for correspondence associated with this application (please read guidance note 13)	
Post town	Post code
Telephone number (if any)	
If you would prefer us to correspond with you by e-mail your e-mail address (optional)	

Epping Forest District Council

Consent of individual to being specified as premises supervisor

I THOMAS ANDREW HOWE (insert name of prospective premises supervisor)

Of  (home address of prospective premises supervisor)

hereby confirm that I give my consent to be specified as the designated premises supervisor in relation to the application for variation of designated premises supervisor

by JUST... AT THE STATION (name of applicant)

relating to premises licence N/A (number of existing licence if any)

for JUST... AT THE STATION LTD
185 HIGH STREET
ROYDON ESSEX CM19 5EA
(name and address of premises to which application relates)

and any premises licence to be granted or varied in respect of this application made by the above applicant concerning the supply of alcohol at the above named premises.

I also confirm that I am applying for, intend to apply or currently hold a personal licence, details of which I set out below.

Personal Licence Number AWAITING (insert personal licence number, if any)

Personal licence issuing authority AWAITING LBWF
(insert name, address and telephone number of issuing authority, if any)

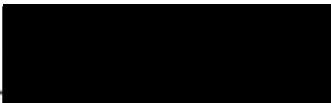
Signed 

Print Name THOMAS ANDREW HOWE

Dated 17/11/15

LICENSE DRAWING FOR RESTAURANT UNIT AT ROYDON STATION

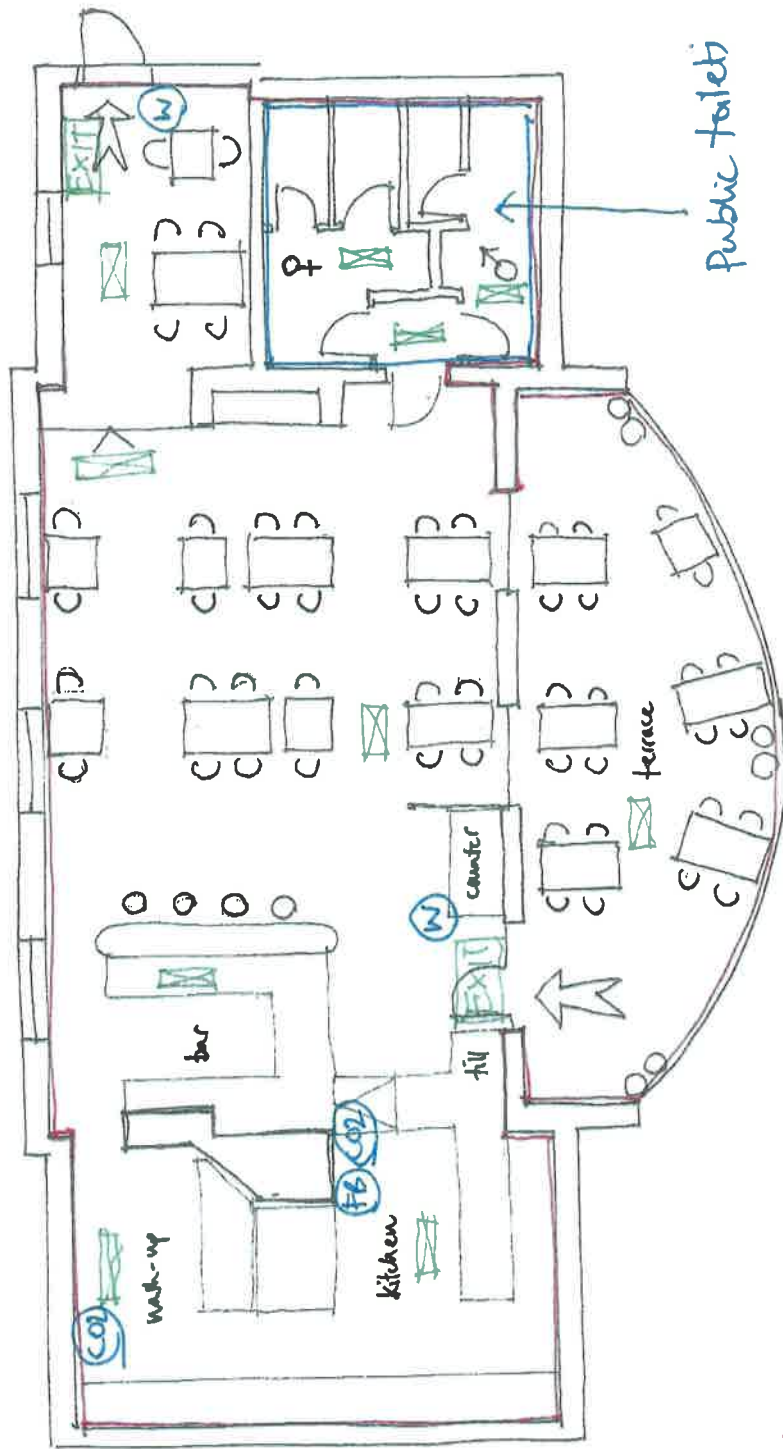

— extent of premises.

☒ emergency lighting.

EXIT emergency exit sign - maintained

☒ fire blanket

☒ CO2 extinguisher

☒ water extinguisher

EXIT

☒ FB

☒ CO2

☒ W

0 5 metres

1:100 @ A4.



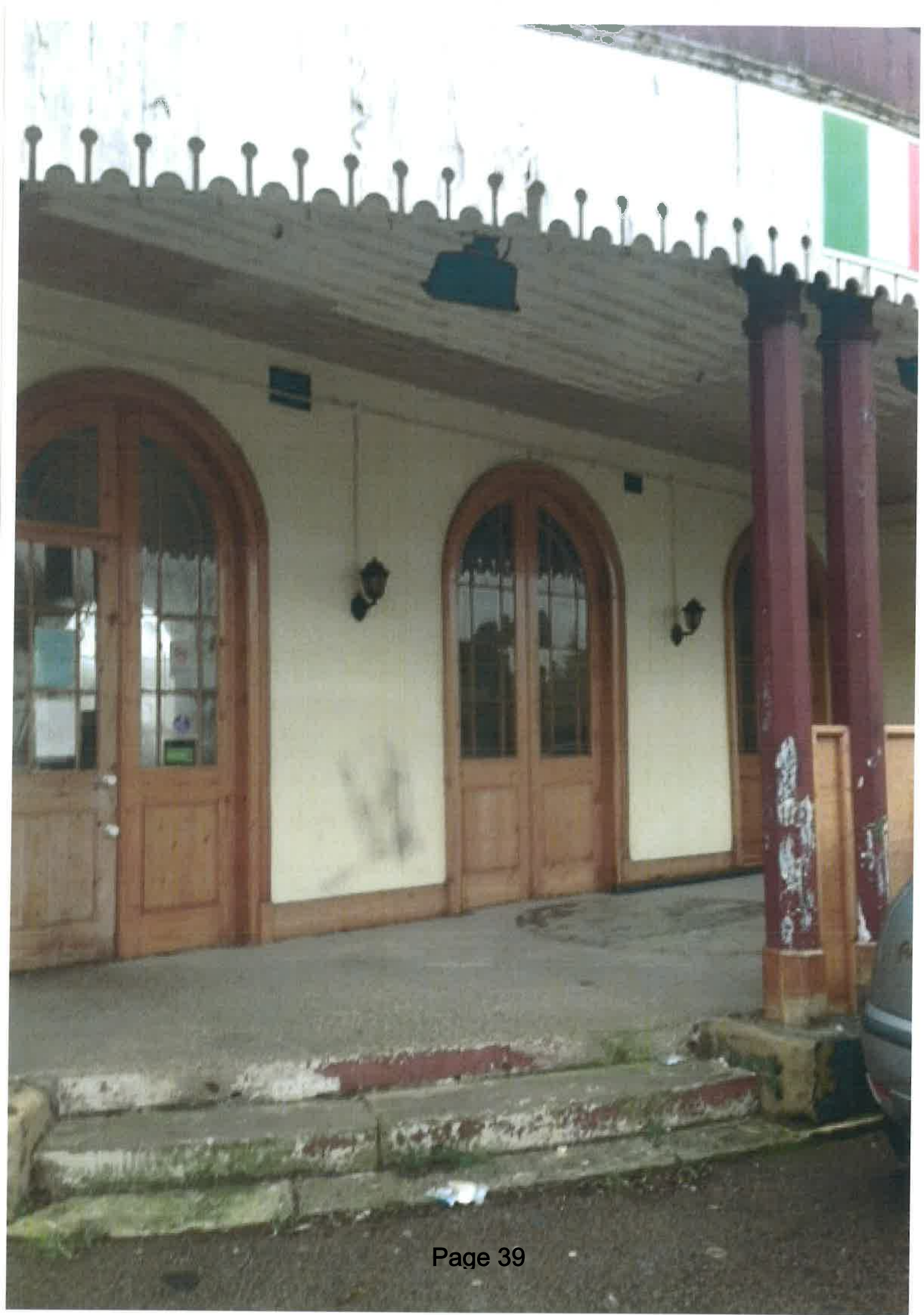

Public Notices

INSOLVENCY ACT 1986

IN BANKRUPTCY HERTFORD COUNTY COURT

NO 71 of 2006 RE JUSTIN MARK BLISS Who at the date of the bankruptcy order 0/2/2006...

In and to pay within four months from 29th December 2015...

Who at the date of the bankruptcy order 0/2/2006, resided at 30 Elm Road...

NOTE: the above named was discharged from the proceedings and may no longer have a connection with the addressee listed.

Mr D Gibson, Official Receiver and trustee

SAVE TIME AND MONEY by selling on your mobile



market PLACE

Planning Notices

NOTICE OF PUBLIC PATH ORDER

TOWN AND COUNTRY PLANNING ACT 1990, SECTION 257 AND PARAGRAPH 1 OF SCHEDULE 14

EAST HERTFORDSHIRE DISTRICT COUNCIL BUNTINGFORD NO. 12 DIVERSION ORDER 2015

The above order was made on 26 November 2015. The effect of the order will be to divert Buntingford Footpath 17 from TL 3658 2959...

A copy of the Order and the Order Plan may be seen free of charge at East Hertfordshire District Council...

If no such representations or objections are made, or if any made are withdrawn, the East Hertfordshire District Council may itself confirm the order as an unopposed order.

Dated: 26 November 2015

Jeff Hughes Head of Democratic and Legal Support Services East Herts District Council

Planning Notices

TOWN AND COUNTRY PLANNING ACT 1990 LOCALISM ACT 2011

Hertingfordbury Parish Council

East Herts Council has received an application for the designation of a Neighbourhood Area.

A copy of the area application can be viewed on the Councils website...

Any interested person may submit representations in relation to the application. These must be made in writing and submitted to East Herts Council by post.

Representations must be received by 5pm on Thursday 17th December 2015.

Please note that any representations submitted will be available for public inspection.

www.eastherts.gov.uk

TOWN AND COUNTRY PLANNING ACTS 1990

The following applications have been made to East Herts Council

Full Application

3/15/191/PUL & 3/15/191/LBC at New House Farm, Weare, SG12 7QT - Conversion of 1st and 2nd floors of buildings to 31 legal separate workspaces...

3/15/219/TUL & 3/15/219/LBC at Grasses Farm, South, Green Tree, Much Hadham, SG10 63P - Converts on and restoration of barn to provide accommodation - full details on website...

3/15/225/FUL & 3/15/225/LBC at Land At Mill Farm, Mentilly Lane, Great Munden, SG11 1JR - Change of use from agriculture to mixed use - agriculture / generation of renewable energy (Solar) - amended scheme.

3/15/220/LBC at The Stable Block, 1 Lewat Water House, Tewin - Remove rear windows to create new door, on east width of current door, internal alterations - full details on website...

3/15/227/LBC at Bennington Park, Bennington, SG2 7RU - Change of use from stables to micro distillery.

3/15/225/LBC at 3 Yeomans Drive, Aston, SG2 7ED - Brick up existing doors, open central archway.

3/15/216/LBC at Skilton Snip, Cherry Green, Westmill, SG9 9NN - New city chimney pot.

3/15/220/HH at 60 Wellington Street, Bengon, SG14 3AW - Proposed side extension.

3/15/224/WH at Walker Mill House 151 1/2 Light Street, Watton, SG2 7NP - Demolition of multiple rooms and proposed extensions - full details on website...

3/15/225/WH at 5 The Chestnuts, Hertford, SG13 8AQ - Two storey front, side and rear extensions insert on of 5no velux rooflights.

3/15/215/WH at 1F Oyle Street, Bengon, SG14 3AL - Ground floor side and first floor rear extensions.

3/15/235/WH at Land At Marshgate Trading Estate, Marshgate Drive, Hertford SG13 7AQ - Renew condition 14 of 3/10/11/77/PN (provision of on site childrens play area) variation of S106 for funding of play provision.

All applications are available on the Councils website but for further details of the locations where you can inspect them, and how to comment on them, please call us on 01729 655761 or visit the Councils website.

The Council gives warning pursuant to its powers under section 225 of the Town & Country Planning Act 1990, that it will remove or otherwise alter any placard or poster displayed illegally within its administrative boundaries of East Hertfordshire District Council.

www.eastherts.gov.uk

TOWN AND COUNTRY PLANNING ACT, 1990

The following applications have been made to Broxbourne Borough Council

Installation of golden gravel shingle driveway to front garden - 19 Wenhovton Cottages Cozens Lane West Wormley EN10 6QJ (Ref: 07/15/1078/HF)

Single storey side and rear extension and demolition of existing conservatory - 52 Stalton Road Broxbourne EN10 7AL (Ref: 07/15/1071/HF)

Installation of 46" advertisement television to front and side elevations - 3 Fawcok Walk Hooedon EN11 8TY (Ref: 07/15/1074/AC)

Roof Terrace - 8 The Coach House Hogges Close Hooedon EN11 8EY (Ref: 07/15/1094/F)

Timber frame outbuilding ancillary to dwelling house at rear of garden for elderly relative - 19 Wenhovton Cottages Cozens Lane West Wormley EN10 6QJ (Ref: 07/15/1093/HF)

Single storey rear extension - 19 Wenhovton Cottages Cozens Lane West Wormley EN10 6QJ (Ref: 07/15/1097/HF)

The above applications may be inspected at www.broxbourne.gov.uk, the Borough Offices, the Council One Stop Shops or any Public Library. Representations must be made within 14 days from the date of this advert.

Douglas Cooper Head of Planning & Development

BUY & SELL wherever you are!

Licensing Notices

Notice of Application for a New Premises Licence under the Licensing Act 2003

Notice is given this day 17th November 2015 that Just... at the station Ltd has applied to the Licensing office of Epping Forest District Council for a Premises Licence in respect of 195 High Street, Roydon, Essex, CM19 5EH

The proposed licence is for: sale of alcohol 11:00-01:00; Recorded music 11:00-01:00; Live music 12:00-01:00; Performance of dance, 12:00-01:00; Provision of facilities for dancing 12:00-01:00; Late night refreshment 23:00-01:30

The register of licensed premises is maintained at the Licensing Office of Epping Forest District Council, Civic Offices, High Street, Epping, Essex, CM16 4BZ. Applications for premises licences may be inspected at this office during office hours.

Any person wishing to oppose this application must give written notice to the Licensing Office within 28 days of this notice.

It is an offence knowingly or recklessly to make a false statement in connection with an application which could lead to a fine on summary conviction (maximum £5000).

Mercury herfordshiremercury.co.uk DATE LOCALLY Life is Local. Here's how to use your Date Locally dating service...

female seeking. DENISE attractive 30's female, amicable warm-hearted romantic, looking for mate to enjoy pamper...

MOBILE LOVE MATCH. WHY SIT AROUND THINKING WHAT IF IN YOUR AREA A MAN ARE WAITING FOR YOUR MESS?

TEXT MATCH TO 89990. DISCREET man wanted by married lady for no strings fun, I'm called Sarah and am 37yrs Phs...

male seeking. TANNED tanned red haired long haired sexy woman looking for a gentleman between 60 to 71 years old...

BUY & SELL wherever you are! MAUREEN discreet sensual lady, 42yrs seeks daytime fun at her home. ACA. Tel: 0906 515 4272 Box: 405287

CUSTOMER SUPPORT Call 0207 720 7130 Monday - Friday 10am - 4pm or email us at support@medialink.co.uk

ADULTS ONLY. Try saucy contacts, its FREE to view visit www.saucycontacts.com

Mrs K Tuckey
Licensing Department
Epping Forest District Council
Civic Offices
High Street
Epping
CM16 4BZ



Licensing Department
Loughton Police Station
158 High Road
Loughton
IG10 4BE
Tel: 01279 625 405
Email: 7706@essex.pnn.police.uk

10 December 2015

Dear Mrs Tuckey,

LICENSING ACT 2003 – GRANT OF PREMISES LICENCE SECTION 17

NEW PREMISE: At The Station, Roydon

DPS: Thomas Howe

APPLICANT: Just...At The Station Ltd

Further to the above application for the Grant of a Premises Licence received on 19 November 2015. I write to inform you that Essex Police make representations under prevention of crime & disorder, prevention of public nuisance and public safety and protection of children from harm.

The premises are in close proximity to a train crossing, with access to live track. It is also close to residential dwellings. For those reasons Essex Police would seek the following conditions.

1. The premises shall install and maintain a comprehensive CCTV system covering the internal and external of the premises. It will also cover all entry and exit points enabling full frontal identification of every person entering in any light condition. The CCTV system shall continually record whilst the premises is open to the public and during all times when customers remain on the premises. All recordings will be kept in an unedited format for a period of not less the 28 days with time and date stamping. Recording shall be made available immediately upon lawful request of Essex Police or other Responsible Authority. Download or export of CCTV should be in the native file format with the native player.

A staff member from the premises who is conversant with the operation of the CCTV system shall be available at all times when the premises are open to the public. This staff member must be able to show Essex Police or other Responsible Authority recent data or footage with the absolute minimum of delay.

2. The external areas of the premises shall not be for the consumption of food or drink.
3. A designated smoking area will be established. After 21:00 daily the smoking area shall be restricted to 5 at any time. No drinks or glassware to be permitted in the smoking area.
4. The premises shall operate a Challenge 25 age verification policy. Any person who appears to be under the age of 25 shall be asked to produce photographic

identification to prove they are 18 or over. Failure to produce will result in service being refused. Acceptable forms of photographic identification include:

- a) Passport,
- b) Photo card Driving Licence,
- c) Photographic ID bearing the 'PASS' hologram.

Should the applicant agree to these conditions prior to the consultation end date 15th December, Essex Police shall withdraw.

Please advise when the Licensing Panel will be meeting to hear this so I can be in attendance.

Yours sincerely,



Mr Peter Jones ABII
Epping & Brentwood Licensing Officer
West LPA

Cc. Just...At The Station Ltd (via email just_atthestation@yahoo.co.uk)

Sarah Moran

From: Peter Jones 42007706 <Peter.Jones@essex.pnn.police.uk>
Sent: 16 December 2015 10:17
To: 'Tom Howe'
Cc: Licensing
Subject: RE: Just...At The Station - Premises Application

Good morning Helen,

Further to the below correspondence, and a long telephone discussion, I am happy to remove proposed condition 2, and amend proposed condition 3 to:

A preferred smoking area will be situated to the left of the premises as you exit.. No drinks or glassware to be permitted in the smoking area.

With that, and Proposed conditions 1 & 2 being agreed, Essex Police are happy to withdraw their representation.

Kind Regards,

Peter Jones ABII (7706)

Epping & Brentwood Licensing Officer
Epping Forest & Brentwood Local Policing Hub
West LPA

Tel. 101 (Ext. 313604) or 01279 625405

Peter.Jones@essex.pnn.police.uk

www.essex.police.uk

Loughton Police Station, 158 High Road, Loughton, Essex, IG10 4BE

To find out what is happening in your neighbourhood and all about your local neighbourhood policing team visit www.essex.police.uk/yourarea and enter your postcode.



ESSEX COMMUNITY MESSAGING

Sign up for free to receive accurate and up-to-date information, crime prevention advice and notifications from Essex Police and other key partners, such as Neighbourhood Watch - simply click the following link <http://www.essex.police.uk/ecm>

From: Tom Howe [mailto:just_atthestation@yahoo.co.uk]
Sent: 14 December 2015 16:13
To: Peter Jones 42007706; Emma Matthews INSP 42002633
Cc: 'just_atthestation@yahoo.co.uk'
Subject: Re: Just...At The Station - Premises Application

Dear Peter,

Further to your email on Friday with the attached letter, I would like to thank you for taking the time to speak to me today.

As we discussed conditions 2 and 3 give me a cause for concern :-

2) The external covered area that is included in the diagram has always been used as an 'alfresco' dining area and as a small restaurant it is integral to our running of the restaurant business and the consuming of food and drink. I would be grateful if you could remove this restriction.

3) Given the restaurant capacity the number of people smoking outside is likely to be minimal. The preferred area for people wishing to smoke would be to the left as you exit the premises where ashtrays would be available for customers to extinguish any cigarettes, as has been done by the previous restaurateur. No drinks or glassware would be permitted outside of the restaurant dining area. It would be onerous on us as a small business to restrict the number of persons smoking at any one time and I would be grateful if this condition could be removed.

I am happy to agree with your other conditions and look forward to working with you in the future.

Kind regards and many thanks,

Helen

On Friday, December 11, 2015, 9:50 AM, Peter Jones 42007706 <Peter.Jones@essex.pnn.police.uk> wrote:

Good Morning,

Please find letter attached relating to the above application,

Many Thanks

Peter Jones ABII (7706)

Epping & Brentwood Licensing Officer

Epping Forest & Brentwood Local Policing Hub

West LPA

 Tel. 101 (Ext. 313604) or [01279 625405](tel:01279625405)

 Peter.Jones@essex.pnn.police.uk

 www.essex.police.uk

 Loughton Police Station, 158 High Road, Loughton, Essex, IG10 4BE

To find out what is happening in your neighbourhood and all about your local neighbourhood policing team visit www.essex.police.uk/yourarea and enter your postcode.

Essex County Fire & Rescue Service

23 NOV 2015



Mr Adam Eckley, MBA, M.I.Fire.E
Acting Chief Fire Officer and Acting Chief Executive

Sarah Moran
Licensing Enforcement Officer
Licensing Unit
Civic Offices
323 High Street
Epping
CM16 4BZ

WEST AREA COMMAND
Harlow Service Delivery Point
Fourth Avenue
HARLOW
CM20 1DU
☎ 01376 576800
✉ westareacommand@essex-fire.gov.uk

Date: 19 November 2015
Our Ref: 70/100091440288
Your Ref:
Enquiries to: Steve Nicholl

Dear Madam,

LICENSING ACT 2003

THE REGULATORY REFORM (FIRE SAFETY) ORDER 2005

Premises: Roydon Station 185 High Street Roydon CM19 5EA

Receipt is acknowledged of the above consultation, which will be audited by the Essex Fire Authority (The Authority).

Should there be any significant concerns regarding the application you will be notified in due course.

Yours faithfully

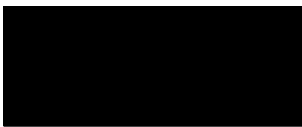

S. W. Nicholl
Technical Fire Safety Officer

Sarah Moran

From: Hasan Erdogan
Sent: 20 November 2015 11:23
To: Sarah Moran (GCSX)
Subject: RE: Licensing Act 2003 New Premises licence application

Hi Sarah,

I have no comments to make regarding the application below.

Thanks,

Hasan

From: Sarah Moran (GCSX)
Sent: 18 November 2015 10:50
To: ECC; ECC 2; eNVIRONMENT AGENCY; Fire; Health and safety; Jackie Renn; Peter Jones; Richard Gardiner (GCSX); Hasan Erdogan; licensing.applications@essex.pnn.police.uk
Cc: [REDACTED]; Democratic Services
Subject: Licensing Act 2003 New Premises licence application

Dear all,

Please be advised that under the Licensing Act 2003 the Licensing Unit has received an application online for a New Premises licence, received on Tuesday 17TH November 2015

Applicant: Just at the Station Ltd

Address of premises: Roydon Station, 185 High Street, Roydon Essex CM19 5EA

Licensable Activities:

New Premises Application – Mediterranean Restaurant

Live Music	Mon – Sun 12.00 – 01.00hrs
Recorded Music	Mon – Sun 11.00 – 01.30hrs
Performances of dance	Mon – Sun 12.00 – 01.00hrs
Dancing	Mon – Sun 12.00 – 01.00hrs
Late night Refreshment	Mon – Sun 23.00 – 01.30hrs
Sale of Alcohol	Mon – Sun 11.00 - 01.00hrs

Consultation Start: Wed 18TH November 2015

Consultation End: Tues 15th December 2015

If you wish to make any representations please do so before **Tuesday 15th December 2015**

Please send any representations to:

Licensing Unit, Civic Offices, 323 High Street, Epping, Essex, CM16 4BZ

Sarah Moran

From: Sue Parker, Business Support Administrator <Sue.Parker2@essex.gov.uk> on behalf of Licence Applications CYP <LicenceApplications@essex.gov.uk>
Sent: 30 November 2015 12:01
To: Licensing
Cc: Just_atthestation@yahoo.co.uk
Subject: 11-2015/14 Just At The Station Ltd Licence Application

RE: Licensing Act 2003:- Just At The Station Ltd

The licensing application received on 25/11/2015 has been assessed and we can confirm we have no objections in relation to the child protection / safeguarding element of this licence application.

Licensing Applications
Quality Assurance & Safeguarding (inc IRO) Service
Family Operations
E2, County Hall
Chelmsford CM1 1YS
Tel: 033301 39797 Email: LicenceApplications@essex.gov.uk

Regards

Sue Parker
Business Support Administrator – BC3
Corporate and Customer Services

Essex County Council
Telephone: 0333 0138888
Email: businesscentre3@essex.gov.uk | www.essex.gov.uk

This email (including any attachments) is intended only for the recipient(s) named above. It may contain confidential or privileged information and should not be read, copied or otherwise used by any other person unless express permission is given. If you are not a named recipient, please contact the sender and delete the email from your system. It is the recipient's responsibility to ensure that appropriate measures are in place to check for software viruses.

Sarah Moran

From: Sarah Moran (GCSX)
Subject: FW: New Premises Application – Mediterranean Restaurant, Roydon Station, 185 High Street, Roydon

From: Mary Sartin [<mailto:marysartin@yahoo.com>]
Sent: 14 December 2015 17:00
To: Sarah Moran (GCSX)
Subject: New Premises Application – Mediterranean Restaurant, Roydon Station, 185 High Street, Roydon

Applicant: Just at the Station Ltd

Address of premises: Roydon Station, 185 High Street, Roydon Essex CM19 5EA

Licensable Activities:

New Premises Application – Mediterranean Restaurant

Live Music	Mon – Sun 12.00 – 01.00hrs
Recorded Music	Mon – Sun 11.00 – 01.30hrs
Performances of dance	Mon – Sun 12.00 – 01.00hrs
Dancing	Mon – Sun 12.00 – 01.00hrs
Late night Refreshment	Mon – Sun 23.00 – 01.30hrs
Sale of Alcohol	Mon – Sun 11.00 - 01.00hrs

Dear Sarah

I wish to register my concerns regarding this application for a new premises licence. I know that there is considerable concern about this application within the vicinity of the premises and beyond as it is perceived as being an opening up to a much wider use than that of just a restaurant.

I will contain my own comments to the licensing objective of Prevention of Public Nuisance which includes noise nuisance. I feel that the proposed sale of alcohol to 1am and late night refreshments to 1.30am could lead to clientele leaving the premises at a time and in a manner which could cause a nuisance particularly to those people living directly opposite the building. The fact that these hours are being sought for 7 days a week also seems excessive for a business which is being run as a restaurant. I would therefore ask that consideration be given to reducing the hours when licensable activities can take place.

I am also concerned that the building, as it stands at present, is not of a structure that will easily contain sound from the activities which could be taking place within it. I would ask that in granting a licence to this premises consideration be given to conditioning ways in which the sound of live and recorded music could be contained within the building and that a noise monitoring policy be put in place.

Regards

Mary Sartin

High Street
Roydon
Essex
CM19 5EQ

From: [REDACTED]

Sent: 13th December 2015

To: licensing@eppingforestdc.gov.uk

Subject: Licence application 'Just at the Station, Roydon' ref. WK/201548144

Dear Sir or Madam

We are not against this application in principle as we have appreciated having a well-run and in-keeping restaurant on the site in the past. It would be good to see a similar business start up.

However, the application to run this as a live music venue, open to the early hours is not a sensible one and we would suggest that it should be toned down on the grounds of Public Safety, prevention of public nuisance and prevention of crime and disorder.

Public safety. The building, being the old station, is immediately adjacent to the main railway line and the level crossing. The line carries express trains to and from Stansted, as well as other traffic. There is nothing to stop people wandering on to the lines if the crossing barriers are up. When the barriers are down pedestrians have to wait to access the southbound platform as there is no pedestrian bridge. Sober people respect this but anyone whose judgment is impaired by alcohol could be tempted to jump the low barriers to catch the last train home, or just to get back into the village.

The location is also adjacent to the river. There have been drownings in the past at other establishments nearby, following late night drinking.

Public nuisance. The village does not have late night public transport. The station is unmanned and has no service information or help with taxis or other transport. We already have people knocking on doors here after falling asleep on the train and getting off confused in Roydon. Late night drinking at the venue would exacerbate this.

The noise from live music every night until 1.30 would be another nuisance.

Crime and disorder. The immediate area and the rail facilities (the waiting area, for example) are prone to vandalism and have to be repaired fairly regularly already. Drinking and this sort of behaviour go hand in hand.

As stated, we are not against a development here but it should be in keeping with other local pubs and restaurants.

[REDACTED]
Nick and Kate Foster

██████████
██████████ High Street
Roydon
Essex
CM19 5EH

11th December 2015

Dear Sirs

RE: Notification of Consultation for Just at the Station Ltd

I am writing to make a representation in respect to the prevention of public nuisance of the Licensing Act 2003 with regards to the licensing hours submitted by Just at Station Ltd, 185 High Street, Roydon, CM19 5EQ.

My family and I (I have two young children) live 10-15 yards from the premises and have done so for 15 years. During our time at ██████ High Street, Roydon we have experienced customers of the restaurant, under the previous occupants, leaving noisily in the early hours of the morning, smoking and drinking outside our property during the day and at night, and customers leaving bottles on our drive and by our fence. We had a good relationship with the previous occupants, however we did have to request some respect to us as a family.

We also had to request the previous occupants to turn down the recorded music after midnight and keep the doors and windows closed to reduce the level of noise and customers also sat on the porch/veranda to eat and drink well into the night especially during the summer months. If the licensing hours are to be extended until the early hours of the morning in an old property with no sound proofing or double glazing, the noise would become even more audible and therefore a public nuisance to us and other nearby residents for a longer period of time.

Whilst we understand this is a new application the hours requested are for much longer than previously and this would lead to customers leaving the restaurant later and drinking and smoking outside into the early hours of the morning. **I would therefore like the committee to consider that all licensing activities between Sunday – Thursday to cease at 23.00 and at Midnight on Friday and Saturday (with the music being turned down at 11.30).**

We would also like the committee to consider where on the property alcohol is drunk and served as the previous occupants allowed alcohol to be consumed within the station car park and outside our property whilst customers smoked. We would like in writing how the applicant will prevent this from happening.

I hope you understand and consider our representation and we await your response.

Yours faithfully

Lynn Barnett
(On behalf of the Barnett family)

Sarah Moran

From: Alan Beal-Forbes [REDACTED]
Sent: 12 December 2015 09:59
To: Licensing
Subject: RE: APPLICATION FOR NEW PREMISES LICENCE UNDER THE 2003 ACT BY JUSTATTHE STATION LTD IN RESPECT OF 185 HIGH STREET ROYDON ESSEX CM195EH

Dear Sirs

With regards to item No.5 of my email of 9/12/15 that as my property [REDACTED] and 191 High Street will be materially affected by various items in the proposed licence(if granted) then in relation to "Live music", "Performance of dance", "Provision of facilities for dancing", "Recorded music" and "late night refreshment" these should be restricted in such licence to Friday and Saturday nights only. Given the area and my description of Roydon village as set out in my said email I would have thought, on consideration, that "Late night refreshment" is entirely inappropriate and unnecessary-is any one getting off the last train from London(00.27 Saturdays and 00.27 Mon-Friday) going to "drop in" for a drink at that hour?

Clearly as Roydon is a commuter village(Abellio Greater Anglia could no doubt supply statistics to you and the applicant) then the timings of everything should be midnight or even 11.30pm(this latter on Sundays).

As a matter of interest ,and importance,to the village ,I assume that Abellio Greater Anglia will be able to comment on the applicant`s application as I assume from the original notice affixed to the exterior window fronting the station forecourt(now quite a few months ago) that AGA is the landlord/owner who would be entitled to grant a lease.No doubt you will establish whether this supposition is correct .Can we assume also that Network Rail was served with a copy of the EFDC Notice as they maintain the rail tracks I believe?

For the avoidance of doubt my comments in this email fall mostly with the grounds of public nuisance and public safety and the other grounds so far as may be relevant to such comments.

I would ask please that these points should be considered by the sub-committee also.

Yours faithfully
Alan Beal-Forbes

From: Alan Beal-Forbes [REDACTED]
Sent: 09 December 2015 19:09
To: 'licensing@eppingforestdc.gov.uk'
Subject: APPLICATION FOR NEW PREMISES LICENCE UNDER THE 2003 ACT BY JUSTATTHE STATION LTD IN RESPECT OF 185 HIGH STREET ROYDON ESSEX CM195EH

TO THE LICENSING TEAM EPPING FOREST DISTRICT COUNCIL CIVIC OFFICES HIGH STREET EPPING CM16 4BX

DEAR SIRS

With regard to the above application I am the owner of [REDACTED] High Street Roydon CM195EH which lies in the immediate vicinity of the subject premises.

Whilst I have no objection to the use of the premises as a "Mediterranean" Restaurant(the term "Mediterranean" being extremely wide as the Mediterranean laps the shores of numerous different countries with differing cultures as can be established by looking at a map in an atlas of that area) I would like bearing in mind the first paragraph to make some observations/objections which I should be glad could be taken into account in the sub-committee`s deliberations as follows:-

1.With regard to the 4 grounds permitted by the 2003 Act and as set out in your undated letter,it is the case(as presumably the sub-committee is aware from the Council`s records) that there are 4 licensed establishments in

Roydon Essex High Street to the "south" of the level crossing at Roydon Station, namely, The New Inn, The Crusader, The White Hart, and The Roydon House and Bar (formerly The White Horse) – the subject premises lying to the "north" of the level crossing immediately adjoining Roydon Station forecourt (being the former Franco's Italian Restaurant). In my view, given the very wide range of items set out in the Notice of Application which the Applicant seems to require, that any license which the sub-committee may be minded to grant, should be similar to and reflect those currently in force in relation to the 4 licensed premises mentioned above and perhaps reflect what was granted to Franco's now defunct restaurant save that the "end" times of each item mentioned in the Notice should be 12 midnight in each case (subject to my observations in item 4 of this email).

2. On the grounds of public safety and the prevention of public nuisance, Roydon High Street (both "north" and "south" of the level crossing) is a quiet residential area generally (except perhaps in the rush hours as presumably the sub-committee is aware) while Roydon itself is essentially a commuter village (serving both London and Cambridge) hence my suggestion that the "end" times in the Notice should be altered to 12 midnight in each case.

3. Also on the grounds of public safety and the prevention of public nuisance, as the sub-committee is aware, smoking within the subject premises is forbidden by statute so this is likely to take place on Roydon Station forecourt (hopefully not on Platform 2) which raise the question of the applicant's clientele drinking on such forecourt (if this permitted under any licence which may be granted and if permitted by Abellio Greater Anglia or other the owner thereof). If this is the case then such area should be properly defined on a plan attached to any licence and somehow indicated to such clientele as it should be borne in mind that such forecourt fronts the main road which is the B181 under the control of Essex CC and is somewhat narrow (as can be seen by inspection) and (as mentioned above) is very busy with heavy traffic during rush hours. Use by commuters and others going to and from the Station carpark (run by NCP) over the forecourt should, I would respectfully suggest, be taken into account when considering what conditions should be included in any proposed licence. This aspect wouldn't apply, as such to any licences relating to the 4 establishments set out above.

4. With reference to the prevention of public nuisance, bearing in mind I do not know what was contained in any licence granted in the past when it was Franco's It. Restaurant and in view of the closeness of both 193 and 191 High Street to the subject premises, please would the sub-committee consider that should the applicant wish to have "live music" (one assumes that this includes bands), "performance of dance", "provision of facilities for dancing" and "late night refreshments", the applicant should be required as one of the conditions in any licence, to make a separate application to the licensing authority on each and every occasion with any timings to fall in line with what might have been granted to the 4 establishments set out above subject to any objections being received or the timings mentioned in item 2 above.

5. Provided I do not exceed the deadline imposed in your Notice of 17th November 2015, I would like (if I may) to reserve the right to put forward any further objections/observations which I might consider of assistance to the sub-committee.

6. I would be pleased if the sub-committee would consider the above points which I trust will be of some assistance in deciding the Applicant's application.

7. I shall be pleased to receive notice of any hearing which might occur in the future and of the ultimate decision by the sub-committee in this matter.

Yours faithfully

Alan Beal-Forbes

Sarah Moran

From: roydon.council@btinternet.com
Sent: 12 December 2015 01:04
To: Licensing
Subject: Just....at the Station Ltd

Dear Licensing

Roydon Parish Council wishes to object to the terms of the license as proposed (notice dated 17th November).

The Parish Council believes that the licensing of these premises until as late as 01.30am would cause unacceptable noise disruption to the neighbouring properties and that a license which is more in keeping with the closing times of the local village public houses would be more appropriate. The business could apply for a late licence on an individual basis but with residential properties so close by we would request that a decibel meter be installed to monitor noise/disruption levels on these occasions as there would be very little in the way of other noise in the village at such a late hour.

Many thanks,

Janet Ballard
Clerk to Roydon Parish Council
P O Box 10752
Bishops Stortford
CM23 9GN

Tel/Fax 01279 730475

This email is intended only for the addressee named above and may contain confidential or privileged information. It must not be copied, forwarded or disclosed to any unauthorised person. If you are not the intended recipient, please notify us immediately by return email. We have taken precautions to minimise the risk of transmitting software viruses, but we advise you to carry out your own virus checks on any attachment to this message. Roydon Parish Council accepts no liability for any loss or damage caused by software viruses.

Sarah Moran

From: Kingsley Sleep <[REDACTED]>
Sent: 11 December 2015 15:52
To: Licensing
Subject: New premises licence for 'Just at the Station'

From: [REDACTED]

Sent: 10th December 2015

To: licensing@eppingforestdc.gov.uk

Subject: Licence application 'Just at the Station, Roydon' ref. WK/201548144

Dear Sir or Madam

I refer to the above application.

There is no public transport available in Roydon after midnight and all means of access to and departure from the village are via unlit country roads mostly without footpaths.

The establishment described is immediately adjacent to an un-gated platform on the London to Stansted Airport and Cambridge main railway line.

Anyone leaving the premises after midnight, in the dark and under the influence of alcohol would create a serious public safety risk to vehicular or train traffic and also to themselves.

By the same token, being inebriated and stranded in the village, they are likely to cause a public nuisance as would the music which it is proposed would continue until 01.00 hrs or 01.30hrs every night of the week.

I am not opposed to the application in principle but strongly feel that its licence should be no different to that of other establishments in the village.

Kingsley Sleep

[REDACTED] The Granary

Roydon, Essex

CM19 5EL

[REDACTED]

Sarah Moran

Subject: FW: Objection to Licence application: Just at the Station, Roydon Station

From: Jill Ludlow [REDACTED]
Sent: 21 November 2015 14:26
To: Licensing
Cc: cllr.anthony.jackson@essex.gov.uk; marysartin@yahoo.com
Subject: Objection to Licence application: Just at the Station, Roydon Station

Dear Sirs

Thank you for your letter of 18 November 2015, ref WK/201548144. I live in The Granary CM19 5EL. I have concerns about overspill parking from Just at the Station ending up in The Granary causing noise and disturbance in the early hours *every day of the week* as customers collect their vehicles. Parking in The Granary is already a problem, in spite of the CPZ and yellow lines. Inconsiderate, hazardous parking and waiting (for commuting passengers from the station) occurs most weekdays, and commuter collection and Just at the Station parking will certainly overlap while the geography of The Granary means on-street parking in much of the road may cause a hazard.

I also have concerns that customers could think the tow path to Roydon Mill would be a good parking spot if there was inadequate provision for free parking. There is a footpath which runs from The Granary between two houses, and where it meets the tow path at the junction with High Street has attracted long term, four wheels-up, parking this year, with subsequent risk to utilities conduited below, as well as inconvenience to pedestrians. When I contacted Essex CC they seemed to think this was not a problem; I'm not convinced the residents of The Granary, which experiences relatively frequent power cuts, share this relaxed view. There are also areas along the towpath at the rear of properties in The Granary, where there is a maintenance/service strip of land between the carriageway and the back fences, which might also prove tempting as overspill parking.

In respect of noise, I do not see that the owners, especially during the summer, would be able to contain the noise of recorded or live music within the confines of the building, and while your letter shows opening times, disbursement of Just at the Station's clientele could carry on long after its advertised closing time of 1.30 am.

Therefore, on the above bases, I formally object to any licence application received by yourselves with the timings currently shown and without adequate and comprehensive plans for free, immediately adjacent parking.

I do so in particular as yesterday I received a letter from Roydon Marina telling of their proposal to increase their number of berths by 252 and this, when taken with the advertised opening time of 11.00 am, leads to concerns about the amount of traffic the combined proposals may generate especially at summer weekends. This year I had cause to contact Epping Forest Noise Abatement after power tools were used on a longboat in conjunction with a generator for two whole days. The additional noise of traffic trying to access Roydon Marina due to inconsiderate parking by longboat owners added to the nuisance.

At present no evidence has been shown that the applicants are taking any appropriate precautions to ensure noise and disturbance at all times, especially in the early hours, *including Sunday*, are minimised and confined to the immediate area. All consequences of Just at the Station's business should remain just at the station.

Yours faithfully
GV Ludlow (Mrs)
[REDACTED] The Granary
Roydon
Essex
CM19 5EL

Sarah Moran

Subject:

FW: Licence Application for "Just at the Station" in Roydon Ref WK/201548144

From: [REDACTED]

Sent: 26 November 2015 14:41

To: Licensing

Cc: [REDACTED]

Subject: Licence Application for "Just at the Station" in Roydon Ref WK/201548144

Dear Sir/Madam,

I have received your letter dated 18th November on the above subject.

I wish to state my objections to the proposal for the following reasons.

1. The premises are small, if not tiny and the floor space is inappropriate for the "Performance of Dance, Live Music, Dancing" as indicated by the licencing application, particularly if the main business is to be as a restaurant - see next point.
2. While the applicant is describing themselves as a "restaurant", they clearly will not do so in the event that they open. If you have restaurant tables you have no room for music and dancing. Hence they are almost certainly looking to be a bar and club with dancing which offers a modest, probably tap type finger menu.
3. The building itself is primarily wood with no double glazing or I believe cavity walls to absorb sound. Hence noise intrusion to local residents from Live Music and Recorded Music will be annoying.
4. Trains from Roydon Station finish just after midnight. If drinking is allowed until 01.30, seven days a week then the only way people can get home will be by taxi or car. If people are allowed by the licencing authority to drink alcohol until well after the last train has left then it could be argued you are encouraging some people to drink drive.
5. Developing the previous point of driving having drunk alcohol, customers will need to drive along unlit, twisting country roads from Roydon where you need all of your wits about you. Drinkers will not be able to do so.
6. It is inconceivable that there is a need for late night drinking, dancing and a live music venue operating into the early hours in Roydon on Sunday, Monday, Tuesday, Wednesday and Thursday evenings. A later licence on Friday and Saturday evenings might be warranted but not beyond midnight.
7. In the village we currently have four bar/restaurants which all operate successfully on normal pub licencing hours. Hence why would a new operation require longer hours - the need has not been proven.
8. If the above is pulled together - the use of the premises as a music venue is in appropriate, there is no demand for a late night venue in Roydon and the noise from the premises themselves and no doubt revellers leaving in the early morning would be an intrusion no one in Roydon would welcome or be exposed to.

Rod Taylor

■ The Granary,

Roydon Essex

CM195EL

Sarah Moran

From: Neil Maurer [REDACTED]
Sent: 14 December 2015 10:54
To: Licensing
Subject: License Application for 'Just at the Station, Roydon'

Your Ref: WK/201548144

Dear Sir/Madam,

I am writing to you concerning the above application for a license for a new restaurant at Roydon station.

This premises is adjacent to the level crossing and only accessible via narrow country lanes or Roydon High Street. The result of this would be that anyone leaving the restaurant late and under the influence of alcohol would face a difficult and possibly hazardous journey home. In addition the allowance of live music playing late could also create a public nuisance.

We have had a restaurant on this site for many years and this was a welcome addition to the village amenities. It would seem to make sense to limit the license to the same as the other pubs and restaurants in the village.

Your Faithfully
Neil Maurer
■ The Granary
Roydon
CM19 5EL

THE ROYDON SOCIETY

Hon Sec: S N Wilkinson, [REDACTED] Harlow Road, Roydon,
Harlow, Essex, CM19 5HH

4 December 2015

Licensing Office
High Street
Epping, Essex
CM16 4BZ

Attn: Ms S Moran

Dear Ms Moran

Just at the Station Ltd, Roydon Station, 185 High Street, Roydon Essex CM19 5EA

Local residents have contacted The Roydon Society of their concerns at the late hours that this new business will be operating which requires a license. Whilst the Society appreciates that the business may wish to attract customers from the later trains that stop at the village station, it is thought that recorded/live music after 11.30pm each evening maybe very disturbing for the residents opposite as well as the residents living nearby in The Granary and towards the village in the High Street. Roydon at that time of night is usually very quiet and as we know for experience noise carries. Residents know only too well that when Briggins Hotel was operating, any loud late music could be heard in the village. I see this application as similar to Briggins operating during these hours.

Local public houses respect local residents and cease music/live performances at a respectable hour. However, I have to add that these performances are held on an ad hoc basis and not possibly every evening as indicated in this application. It may well be that this new business finds it more sensible to ask for a license to cover the whole week rather than apply for such a license for 'special' occasions. Maybe this could be confirmed?

Please keep me informed of the progress of this application.

Yours sincerely,

[REDACTED]

S N Wilkinson - Hon Sec

Tel: (01279) [REDACTED]

Fax: (01279) [REDACTED]

email: [REDACTED]

[REDACTED] High Street,

Roydon,

Nr. Harlow,

Essex. CM19 5EQ

4.12.15.

Dear Sir,

As houseolders of Roydon village, in proximity to the station, we welcome the renewed use of the restaurant facility which has now become dispidated.

We do have concerns and these relate to extended hours for serving alcohol and a licence for live and recorded music continuing after midnight.

The high street already suffers from noise and discarded litter from pub users. There is also very limited parking at the restaurant and possible danger to any person seriously inebriated. One drowning

has occurred under such circumstances reported in the last 5 years.

The river towpath, canal bridge and level crossing are all within 20 metres of the station.

We request that these facts are considered before the requested licences are granted.

Yours faithfully,

A large black rectangular redaction box covering the signature area.

(D.S. & B.J. NAIRN)

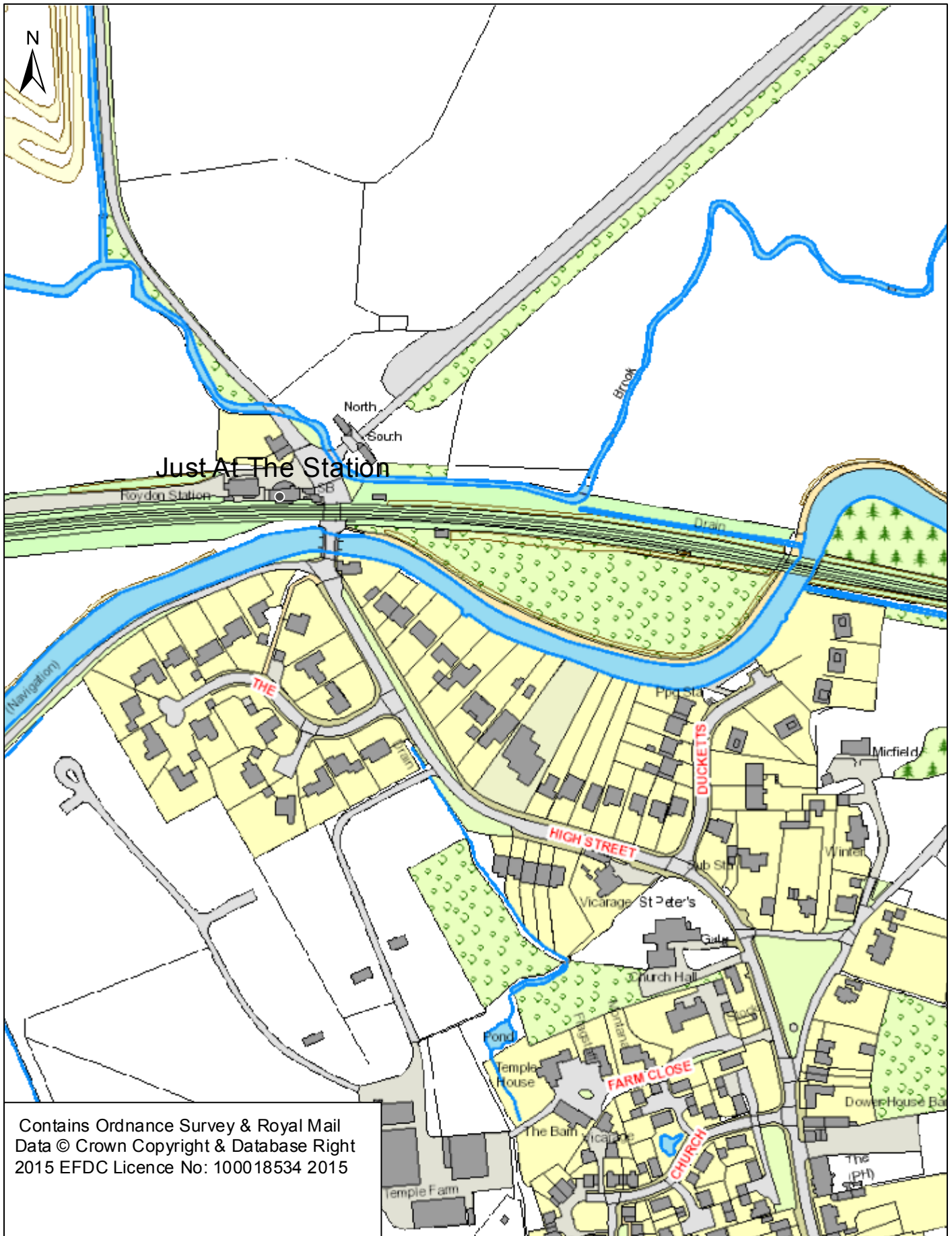

Contains Ordnance Survey & Royal Mail
 Data © Crown Copyright & Database Right
 2015 EFDC Licence No: 100018534 2015

This page is intentionally left blank